

Bennett & Francis Pty. Ltd. A.C.N. 053 307 172
 certify that the details shown on this
 sketch plan are correct.
 Licensed Surveyor
 A.C.N.
 053 307 172
 Director
 COMMONWEALTH
 Date: 25/09/2006

TITLE REFERENCE
 18195037

PLAN FOR LEASE PURPOSES

(Being part of the First Floor of a two storey office building)

Of LEASE IIB
 In Lot 1 on RP115818,
 Original Portion 136,
 Parish of Yeerongpilly
 County of Stanley.

ALL AREAS SHOWN HEREON ARE
 CALCULATED TO THE NEAREST
 SQUARE METRE.



Bennett & Francis Pty. Ltd.
 Surveying, Cartography, Computing,
 Mapping, Town Planning.
 ACN. 053 307 172
 35 Peel Street,
 South Brisbane, Q.4101,
 Phone (07) 3239 5444
<http://www.bfsurveys.com.au>

Drawn BD	Date 25-09-06
F.W. JRW	F.B. 06-024
File 01979401	Checked JRW
Scale 1:2500	Approved JRW
Plan Ref. 019794.01	

DIAGRAM

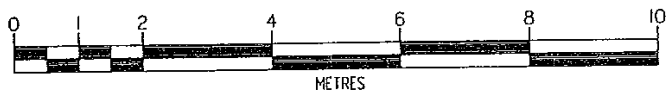
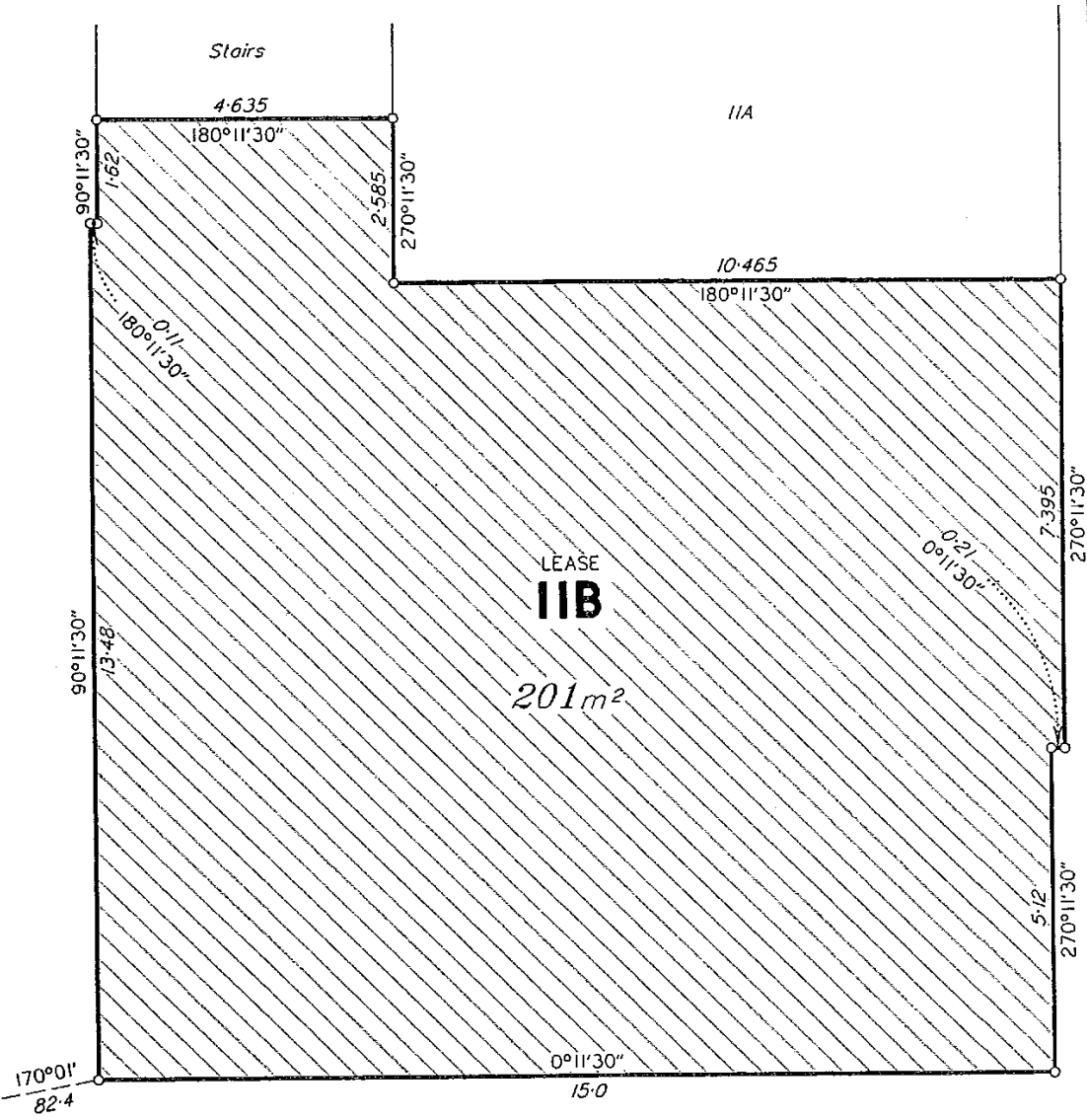

Tenancy measured in accordance with Net Lettable Area – Office Buildings (NLA) as defined in Property Council of Australia Limited March 1997 Method of Measurement.

Plan Ref. 019794.01

Handwritten mark or signature.