



BENNETT + BENNETT

Property Consultants, Surveyors + Town Planners

All mail to: PO Box 5021, GCMC., Qld. 9726
mail@bennettandbennett.com.au

GOLD COAST OFFICE 95 Upton Street, Bundall, 4217 Ph (07) 5574 0733	COOMERA OFFICE 9 Jowett Street, Coomera, 4209 Ph (07) 5573 6177
--	---

BRISBANE OFFICE Suite 1, 189 Kelvin Grove Road Kelvin Grove, 4059 Ph (07) 3839 7200	IPSWICH OFFICE Suite 5, 5-11 Downs Street North Ipswich, 4305 Ph (07) 3202 1575
--	--

SUNSHINE COAST OFFICE
Suite 1.8, 20 Innovation Parkway,
Birtinya, 4575
Ph (07) 5438 8104

Rev	Date

- NOTES:**
1. Drawn to Scale on A3 sheet
 2. Lease area measured in accordance with the P.C.A. recommendations for G.L.A (Gross Lettable Area).
 3. Title Reference : 17329215.
 4. Adjoining tenancies shown have been compiled from other sources and are diagrammatic only.
 5. Lease Boundaries are defined by structural elements, distances shown are indicative only unless noted otherwise.

TITLE

**Plan of
Lease Area 1A**
being part of the Ground
Floor of the building erected
on Lot 1 on GTP 2050

CLIENT INCO PROPERTY GROUP		
Drawn	ARS	Parish TOOMBUL
Surv'd	JC	County STANLEY
Approved	CW	Job Ref. 10077
L/Book		Comp File 10077.ccx
Date	30/9/2013	Dwg File 10077LEA10
SCALE	1:250	PLAN No. 10 Rev.



NUDGE ROAD

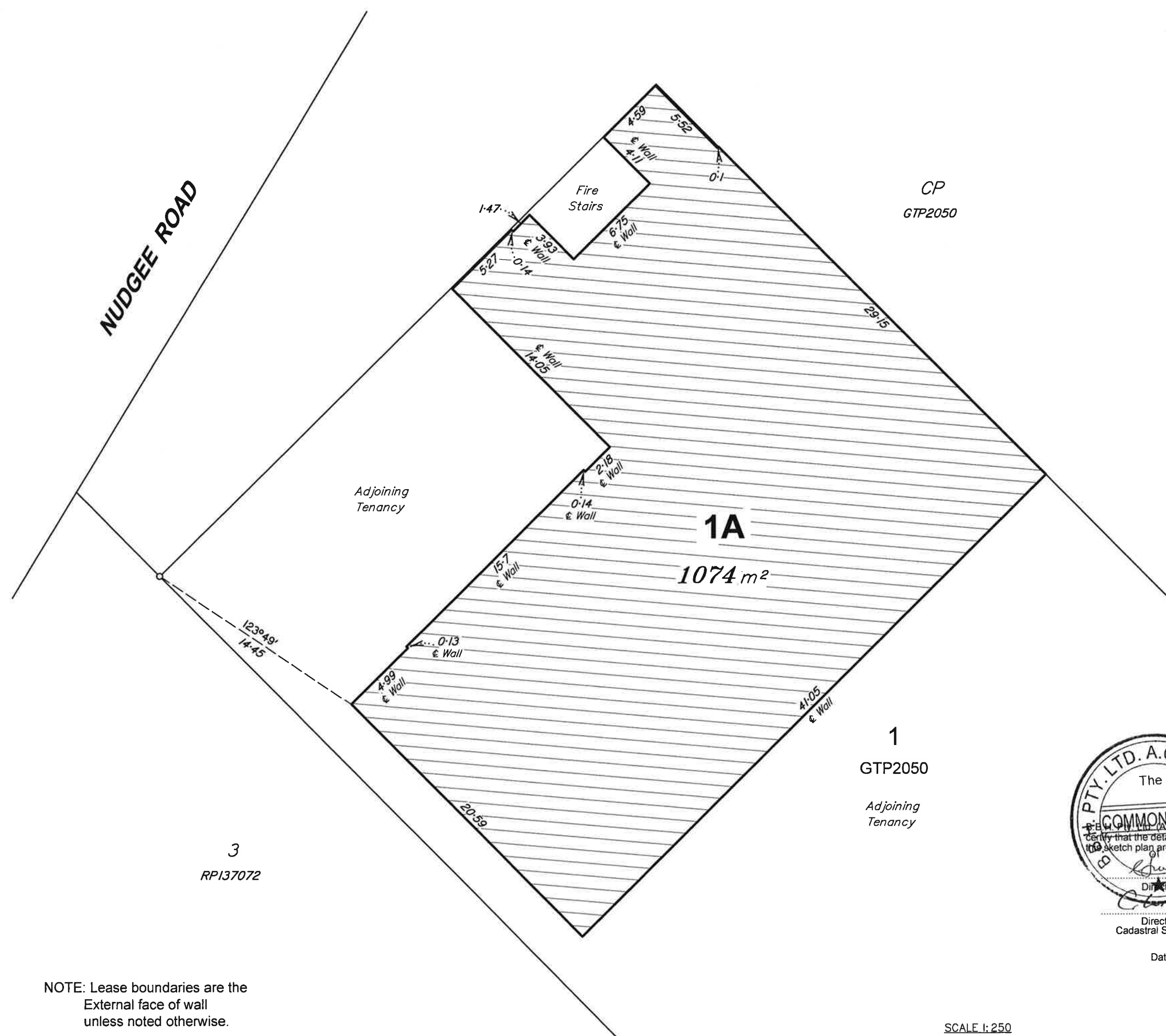

Director
Cadastral Surveyor
Date... 1/10/13

NOTE: Lease boundaries are the External face of wall unless noted otherwise.

