

STATION

ROAD

21
SP117132
(Railway)

RP217835

247
SEE DIAGRAM

3
RP37684
Moolabin
Creek

I, Christopher Terence Swane,
cadastral surveyor/director of
BBH Pty Ltd (ACN 010 427 531),
certify that the details shown
on this sketch plan are correct.

Cadastral Surveyor/Director

Date: 15.09.2009



SCALE 1:1500



NOTE: Lease boundaries are the external
faces of walls unless noted otherwise.

DIAGRAM

Scale 1:400

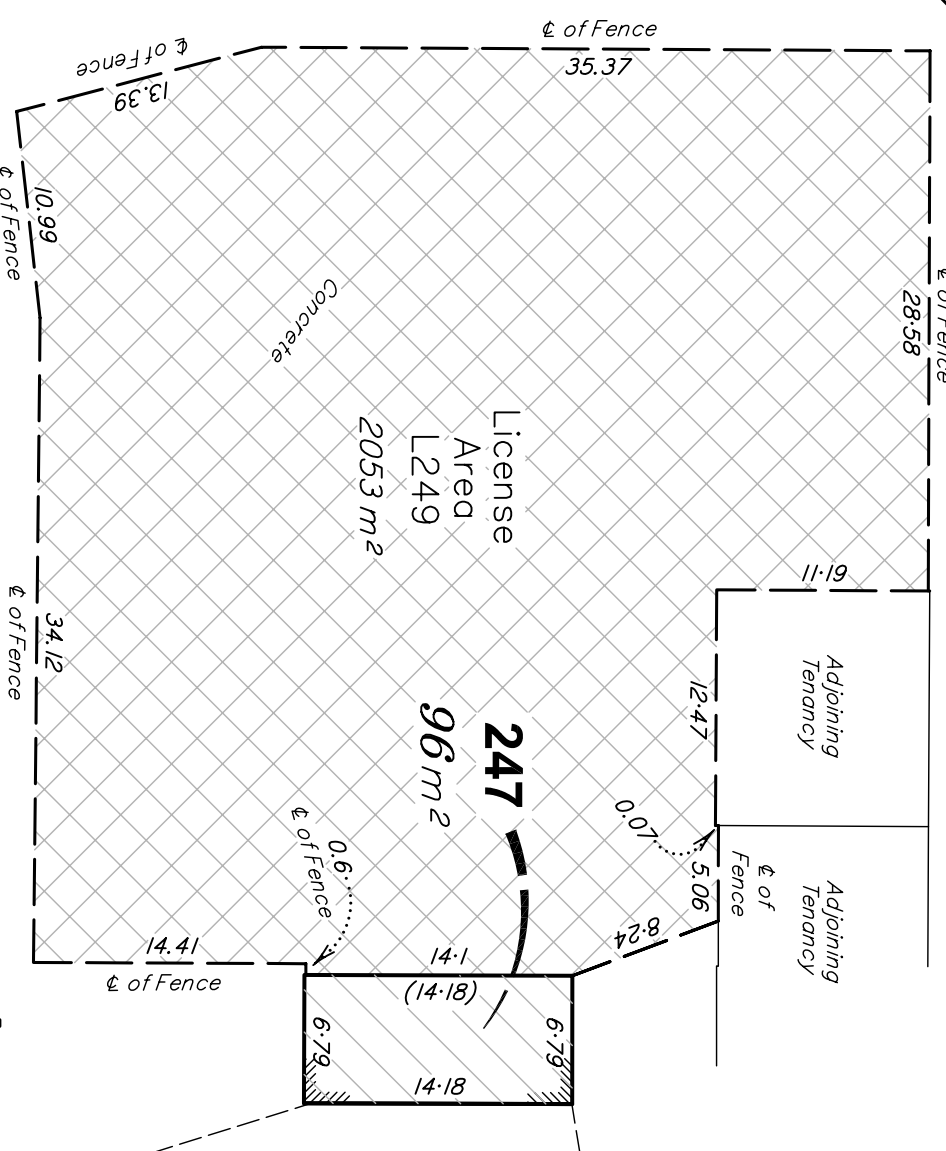

RP217835



BENNETT + BENNETT

Property Consultants, Surveyors + Town Planners

All mail to: PO Box 5021, GCMC., Qld. 9726
mail@bennettandbennett.com.au
BBH Pty. Ltd. A.C.N. 010 427 531

GOLD COAST OFFICE
95 Upton Street,
Bundall, 4217
Ph (07) 5574 0733
Fax (07) 5574 0202

COOMERA OFFICE
9 Jowett Street,
Coomera, 4209
Ph (07) 5573 6177
Fax (07) 5529 4342

BRISBANE OFFICE
Level 3,
490 Upper Edward St.
Spring Hill, 4004
Ph (07) 3839 7200
Fax (07) 3839 7277

IPSWICH OFFICE
Suite 5,
5-11 Downs Street,
North Ipswich, 4305
Ph (07) 3202 1575
Fax (07) 3202 1576

Rev	Date

NOTES:

1. Drawn to Scale on A3 sheet
2. Lease area measured in accordance with the P.C.A. recommendations for G.L.A. (Gross Lettable Area.)
3. Title Reference : 17265066.
4. Adjoining tenancies shown have been compiled from other sources and are diagrammatic only.
5. Lease Boundaries are defined by structural elements, distances shown are indicative only unless noted otherwise.

TITLE
"PLAN OF LEASE
AREA 247 & LICENSE
AREA 249"
being part of the Ground Floor
of one of the buildings erected
on Lot 1 on RP 217835

CLIENT
F & M DRAKE PROPERTIES

Drawn	Parish
JPC	YEERONGPILLY
Surv'd	County
CJP	STANLEY
Authorised	Job Ref.
	08292
L/Book	Comp File

Date	Dwg File	
15.09.2009	08292LEA16	
SCALE	PLAN No.	Rev.
1:1500	18	

STATION

ROAD

21
SP117132
(Railway)

RP217835

3
RP37684
Moolabin
Creek

247
SEE DIAGRAM

2
RP217835

NOTE: Lease boundaries are the external faces of walls unless noted otherwise.

DIAGRAM

Scale 1: 400

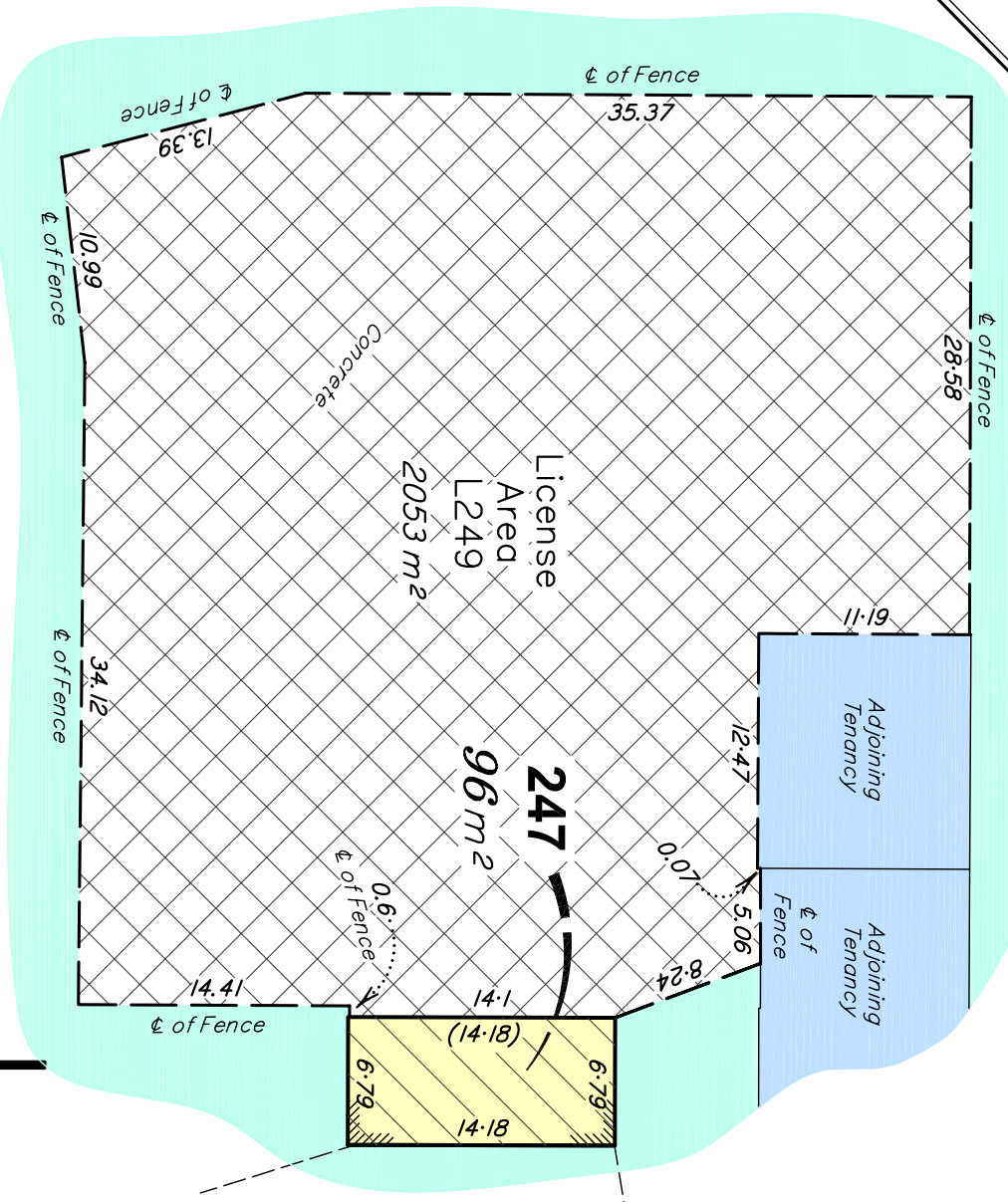

SCALE 1: 1500

RP217835



BENNETT + BENNETT

Property Consultants, Surveyors + Town Planners

All mail to: PO Box 5021, GCMC, Qld. 9726
mail@bennettandbennett.com.au
BBH Pty, Ltd. A.C.N. 010 427 531

GOLD COAST OFFICE 95 Upton Street, Bundall, 4217 Ph (07) 5574 0733 Fax (07) 5574 0202	COOMERA OFFICE 9 Jowett Street, Coomera, 4209 Ph (07) 5573 6177 Fax (07) 5529 4342	IPSWICH OFFICE Suite 5, 5-11 Downs Street North Ipswich, 4305 Ph (07) 3202 1575 Fax (07) 3202 1576
--	---	--

Rev	Date

NOTES:

1. Drawn to Scale on A3 sheet
2. Lease area measured in accordance with the P.C.A. recommendations for G.L.A. (Gross Lettable Area.)
3. Title Reference : 17265066.
4. Adjoining tenancies shown have been compiled from other sources and are diagrammatic only.
5. Lease Boundaries are defined by structural elements, distances shown are indicative only unless noted otherwise.

TITLE
"PLAN OF LEASE
AREA 247 & LICENSE
AREA 249"
being part of the Ground Floor
of one of the buildings erected
on Lot 1 on RP 217835

CLIENT
F & M DRAKE PROPERTIES

Drawn	JPC	Parish	YEERONGPILLY
Surv'd	CJP	County	STANLEY
Authorised		Job Ref.	08292
L/Book		Comp File	
Date	15.09.2009	Dwg File	08292LEA16
SCALE	1: 1500	PLAN No.	18
		Rev.	