

STATION

ROAD

21
SP117132
(Railway)

3
RP37684
**Moolabin
Creek**

RP217835

2
RP217835

RP217835

245
SEE DIAGRAM

104°01'30"
232.27

78.88
225°32'40"

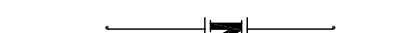

NOTE: Lease boundaries are the external faces of walls unless noted otherwise.

DIAGRAM

Scale 1:150

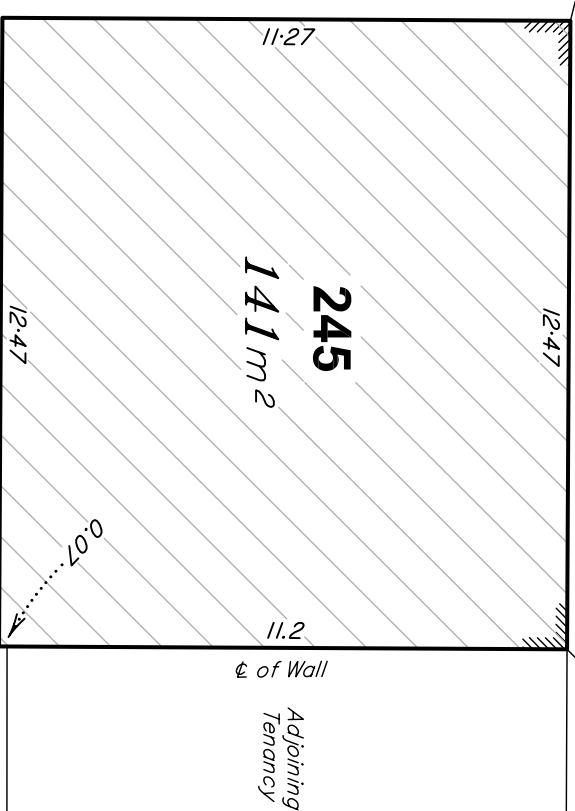

I, Christopher Terence Swane, cadastral surveyor/director of BBH Pty Ltd (ACN 010 427 531), certify that the details shown on this sketch plan are correct.

Christopher Swane

Cadastral Surveyor/Director

Date: 15.09.2009

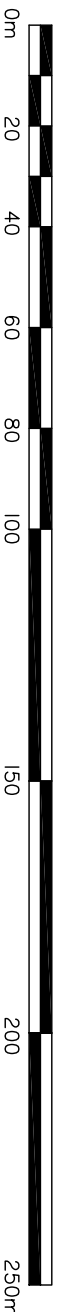

SCALE 1:1500



BENNETT + BENNETT

Property Consultants, Surveyors + Town Planners

All mail to: PO Box 5021, GCMC., Qld. 9726
mail@denntandbennett.com.au
BBH Pty. Ltd. ACN. 010 427 531

GOLD COAST OFFICE
95 Upton Street,
Bundall, 4217
Ph (07) 5574 0733
Fax (07) 5574 0202

COOMERA OFFICE
9 Jowett Street,
Coomera, 4209
Ph (07) 5573 6177
Fax (07) 5529 4342

BRISBANE OFFICE
Level 3,
490 Upper Edward St.
Spring Hill, 4004
Ph (07) 3839 7200
Fax (07) 3839 7277

IPSWICH OFFICE
Suite 5,
5-11 Downs Street,
North Ipswich, 4305
Ph (07) 3202 1575
Fax (07) 3202 1576

Rev	Date

NOTES:

1. Drawn to Scale on A3 sheet
2. Lease area measured in accordance with the P.C.A. recommendations for G.L.A. (Gross Lettable Area.)
3. Title Reference : 17265066.
4. Adjoining tenancies shown have been compiled from other sources and are diagrammatic only.
5. Lease Boundaries are defined by structural elements, distances shown are indicative only unless noted otherwise.

TITLE

**"PLAN OF LEASE
AREA 245 "**

being part of the Ground Floor
of one of the buildings erected
on Lot 1 on RP 217835

CLIENT
F & M DRAKE PROPERTIES

Drawn JPC Parish YEERONGPILLY

Surv'd CJP County STANLEY

Authorised Job Ref. 08292

L/Book Comp File

Date 15.09.2009 Dwg File 08292LEA17

SCALE 1:1500 PLAN No. 19 Rev.

STATION

ROAD

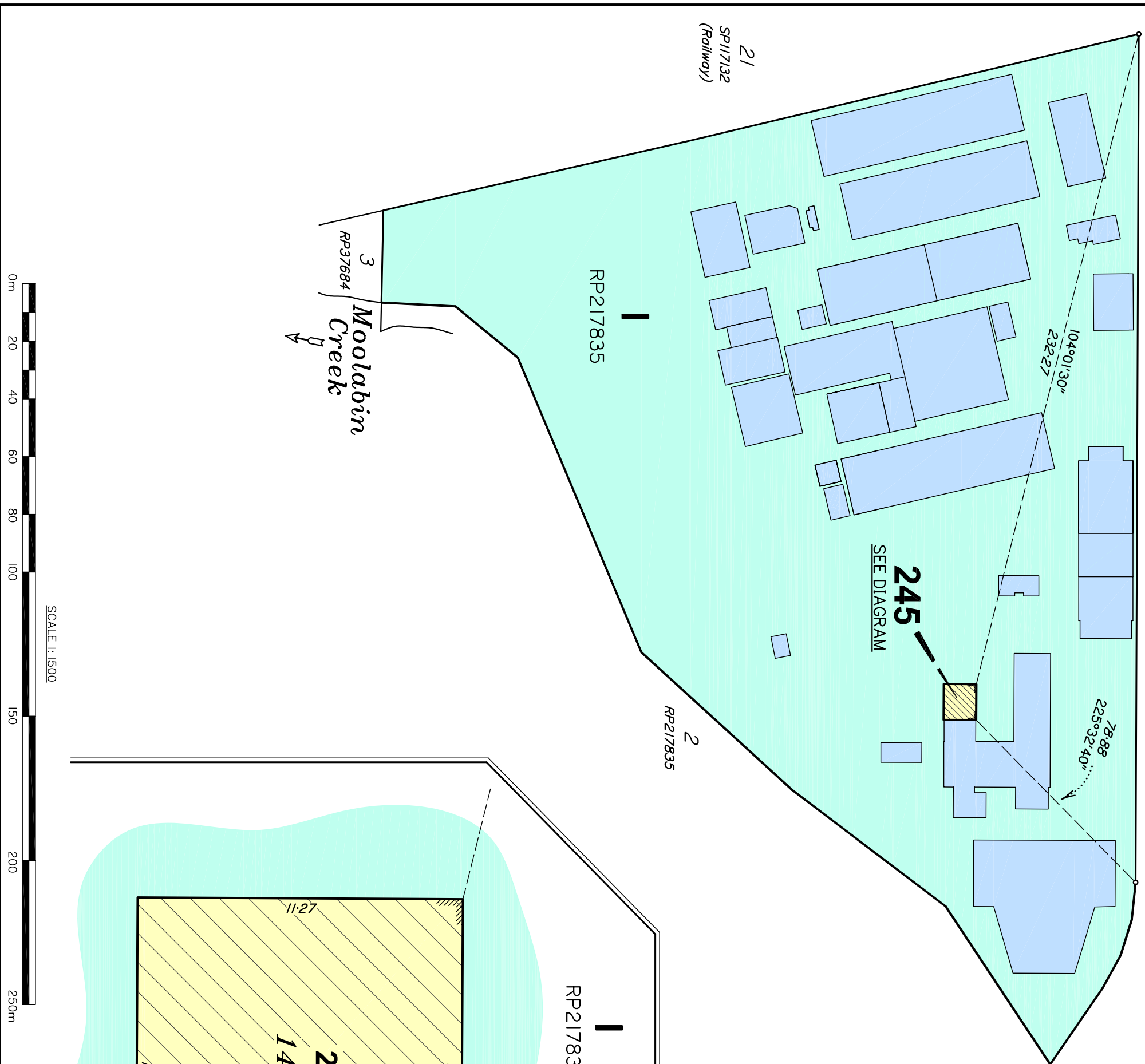

NOTE: Lease boundaries are the external faces of walls unless noted otherwise.

DIAGRAM
Scale 1: 150

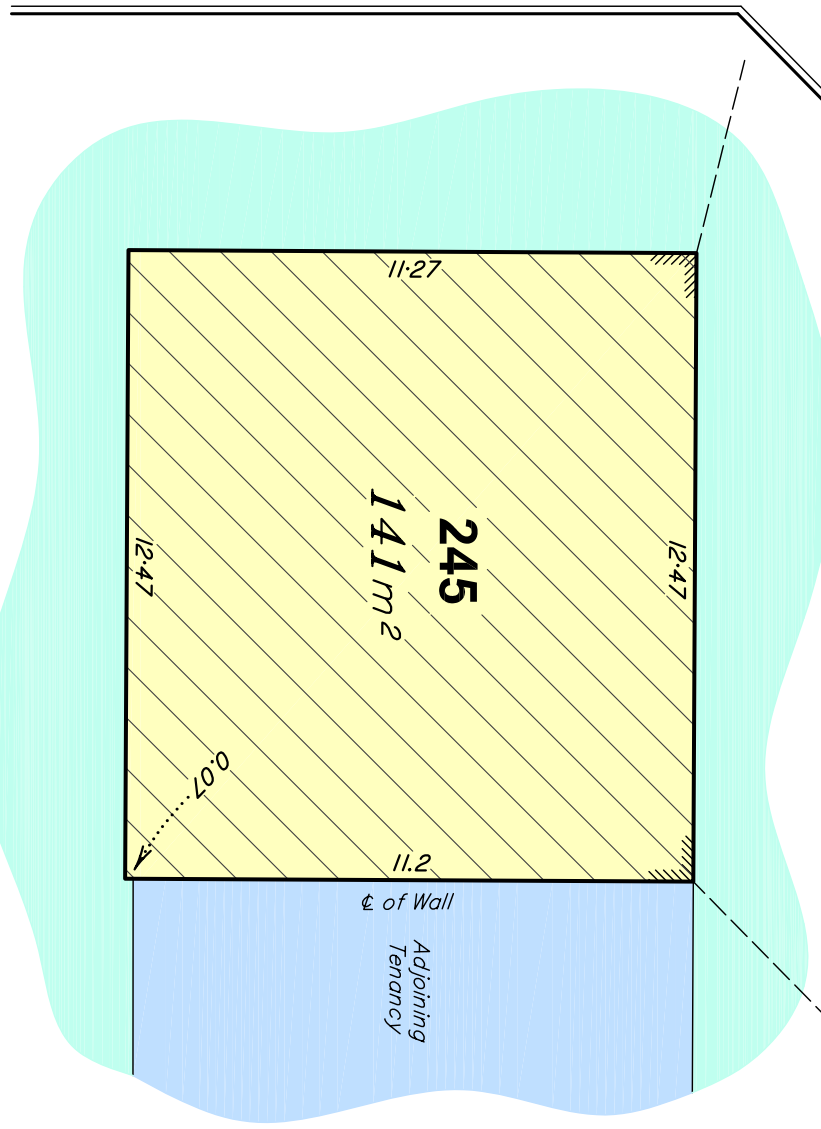

BENNETT + BENNETT

Property Consultants, Surveyors + Town Planners
 All mail to: PO Box 5021, GCMC, Qld. 9726
 mail@bennettandbennett.com.au
 BBH Pty. Ltd. A.C.N. 010 427 531

GOLD COAST OFFICE 95 Upton Street, Bundall, 4217 Ph (07) 5574 0733 Fax (07) 5574 0202	COOMERA OFFICE 9 Jowett Street, Coomera, 4209 Ph (07) 5573 6177 Fax (07) 5529 4342
BRISBANE OFFICE Level 3, 490 Upper Edward St. Spring Hill, 4004 Ph (07) 3839 7200 Fax (07) 3839 7277	IPSWICH OFFICE Suite 5, 5-11 Downs Street North Ipswich, 4305 Ph (07) 3202 1575 Fax (07) 3202 1576

Rev	Date

- NOTES:
1. Drawn to Scale on A3 sheet
 2. Lease area measured in accordance with the P.C.A. recommendations for G.L.A. (Gross Lettable Area.)
 3. Title Reference : 17265066.
 4. Adjoining tenancies shown have been compiled from other sources and are diagrammatic only.
 5. Lease Boundaries are defined by structural elements, distances shown are indicative only unless noted otherwise.

TITLE	
"PLAN OF LEASE AREA 245"	
being part of the Ground Floor of one of the buildings erected on Lot 1 on RP 217835	
CLIENT	
F & M DRAKE PROPERTIES	
Drawn	JPC Parish YEERONGPILLY
Surv'd	CJP County STANLEY
Authorised	Job Ref. 08292
L/Book	Comp File
Date	Dwg File 08292LEA17
15.09.2009	PLAN No. 19
SCALE 1:1500	Rev.